

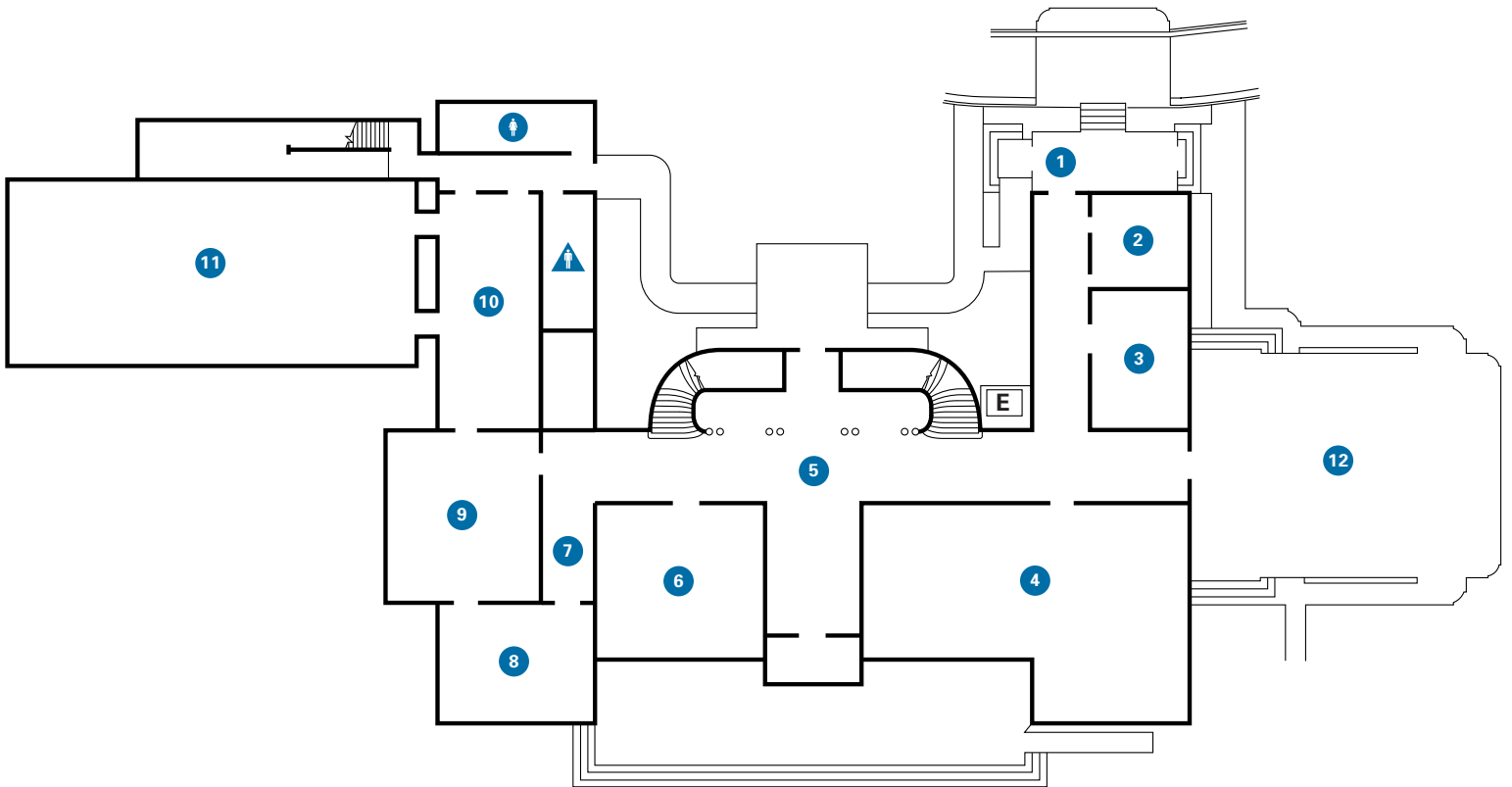

Floor Plan—First Floor



-  Women's Room
-  Men's Room
- E** Elevator



- | | |
|---|---|
| 1 Entrance | 8 Small Drawing Room |
| 2 Reception | 9 Dining Room |
| 3 Small Library | 10 Anteroom: 17th- and early 18th-century portraits |
| 4 Large Library | 11 Thornton Portrait Gallery |
| 5 Hallway: 18th-century art | 12 Loggia |
| 6 Large Drawing Room | |
| 7 Early miniatures, silver medals, and 18th-century French snuffboxes | |

Floor Plan—Second Floor

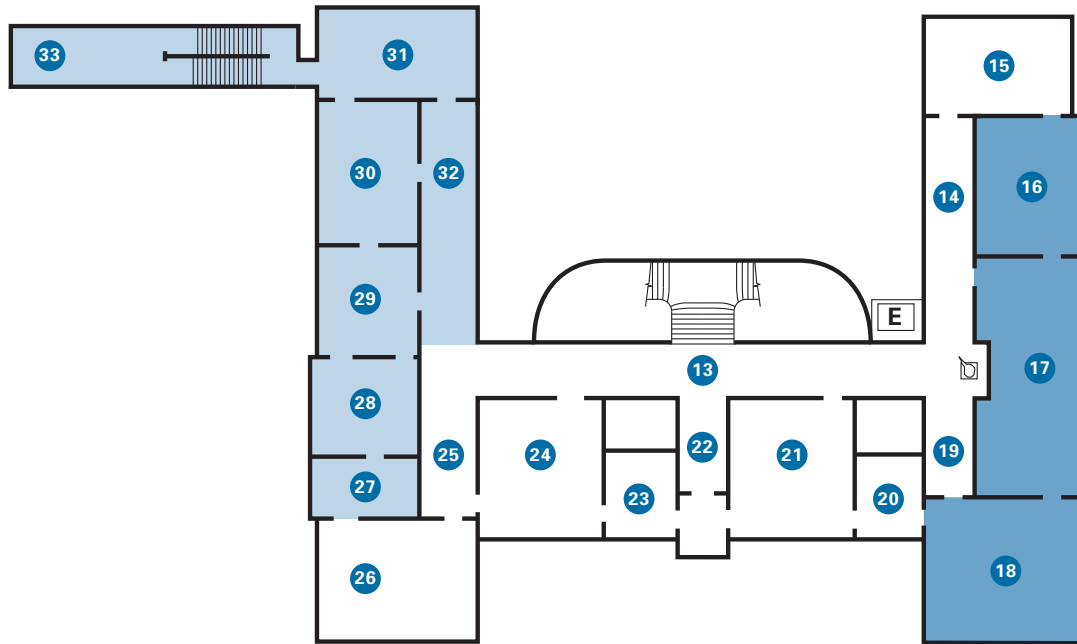

- Newly converted to gallery space
- Newly configured area
- E** Elevator



- | | |
|---|---|
| 13 Hallway: Jean-Antoine Houdon's <i>Diana the Huntress</i> | 24 British art: questions of style |
| 14 Renaissance paintings and furniture | 25 Miniatures and early-19th-century oil sketches |
| 15 Renaissance sculpture and 17th-century Dutch paintings | 26 British art: 1800–25 |
| 16 French art: paintings and small sculpture | 27 British art: works on paper |
| 17 French art: tapestry, sculpture, and furniture | 28 British art: 1825–50 |
| 18 French art: Sèvres porcelain, furniture, and sculpture | 29 British art: Design Reform Movement, ca. 1850 |
| 19 18th-century Italian paintings | 30 British art: William Morris and Co., 1860–80 |
| 20 Focus Room: ceramics | 31 British art: 1880–1920 |
| 21 British art: the domestic sphere | 32 French art: 19th-century paintings |
| 22 Wedgwood vases | 33 Morris and Co. stained glass window |
| 23 Focus Room: silver | |